

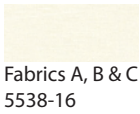

Wishes Quilt Along Block Two - Double Windmill



Fabrics A, B & C
5538-16



Fabrics D, E & F
5530-22



Fabrics D, E & F
5535-23



Fabrics D, E & F
5531-24



Fabrics D, E & F
5537-11



Cutting:

A	8	2 7/8" squares
B	8	2 3/8" squares
C	16	2" x 2 1/2" rectangles
D	2	2 7/8" squares (from each Fabric D)
E	4	2" x 2 1/2" rectangles (from each Fabric E)
F	2	2 3/8" squares (from each Fabric F)

Use 1/4" seams and press as arrows indicate throughout.

Draw a diagonal line on the wrong side of the Fabric A squares. With right sides facing, layer a Fabric A square with a Fabric D square.

Stitch 1/4" from each side of the drawn line.

Cut apart on the marked line.

Fabric A/D Half Square Triangle Unit should measure 2 1/2" x 2 1/2".

Make sixteen total.



Draw a diagonal line on the wrong side of the Fabric B squares. With right sides facing, layer a Fabric B square with a Fabric F square.

Stitch 1/4" from each side of the drawn line.

Cut apart on the marked line.

Fabric B/F Half Square Triangle Unit should measure 2" x 2".

Make sixteen total.

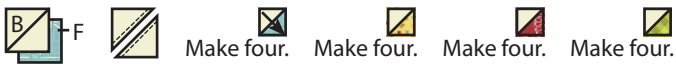

Assemble one Fabric A/D Half Square Triangle Unit, one Fabric C rectangle, one Fabric E rectangle and one Fabric B/F Half Square Triangle Unit as shown.

Small Windmill Unit should measure 4" x 4".

Make sixteen total.

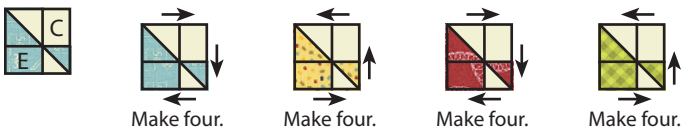

Assemble four Small Windmill Units as shown.

Large Windmill Unit should measure 7 1/2" x 7 1/2".

Make four total.

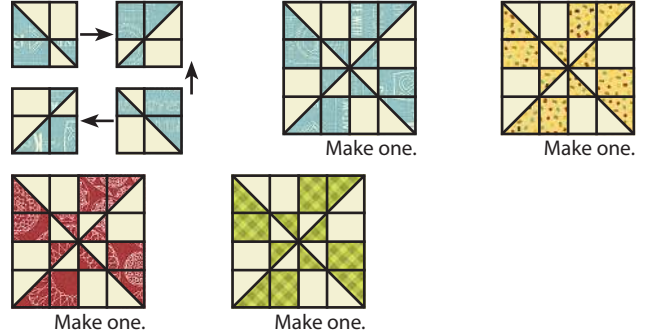

Assemble Block Two as shown.

Block Two should measure 14 1/2" x 14 1/2".

Make one.

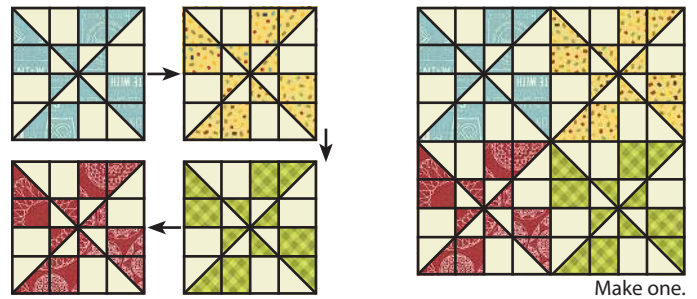

MAKE-A-WISH.

Central & South Texas

You can help by donating to Make-A-Wish through the [Wishes Quilt Along donation page](#).

