



Wishes Quilt Along Block One - Flying Kite



Cutting:

- A 1 8 1/4" square
- B 4 2 3/8" x 7 7/8" rectangles
- C 1 8 1/4" square (from each Fabric C)
- D 1 6" x 7 7/8" rectangle (from each Fabric D)

Use 1/4" seams and press as arrows indicate throughout.

Cut the Fabric A square and the Fabric C squares on the diagonal twice.

You will not use all Fabric C triangles.

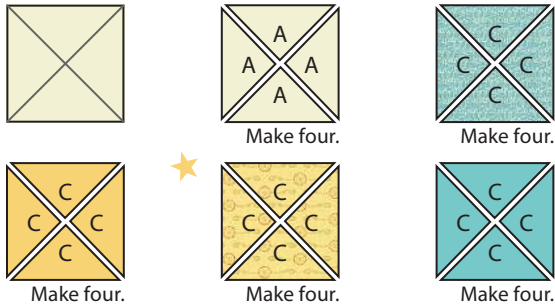

Assemble one Fabric A triangle and one Fabric C triangle as shown.

Make four total.

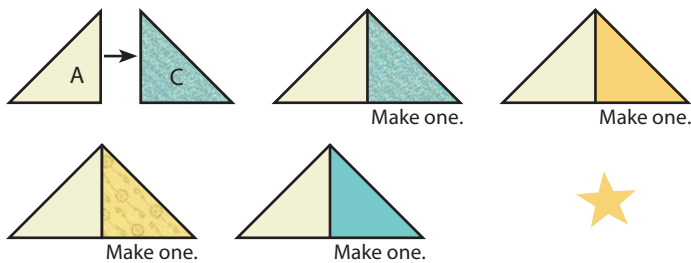

Assemble one Fabric B rectangle and one Fabric D rectangle as shown.

Fabric B/D Unit should measure 7 7/8" x 7 7/8".

Make four total.



Cut the Fabric B/D Units on the diagonal once. Pay close attention to the direction of the cut line.

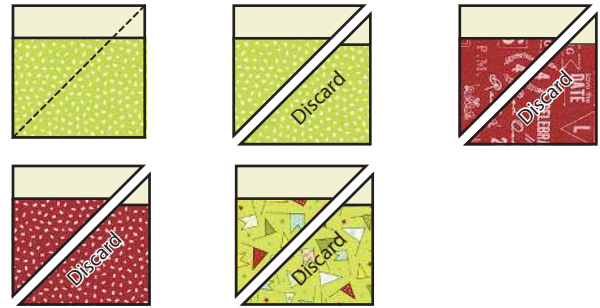

Assemble one Fabric A/C Unit and one Fabric B/D Unit as shown.

Flying Kite Unit should measure 7 1/2" x 7 1/2".

Make four total.

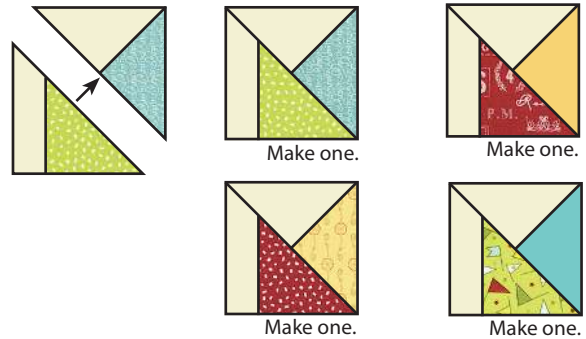

Assemble Block One as shown.

Block One should measure 14 1/2" x 14 1/2".

Make one.

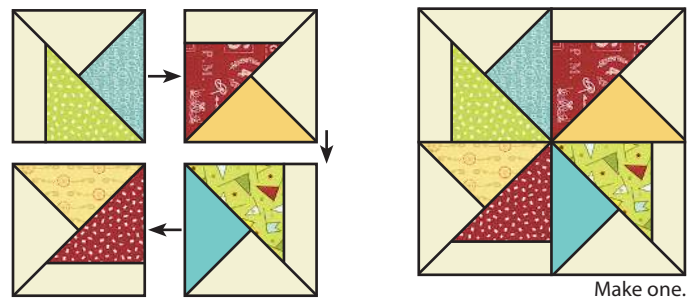

MAKE-A-WISH.
Central & South Texas

You can help by donating to Make-A-Wish through the [Wishes Quilt Along donation page](#).

