









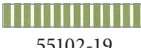

snapshots QUILT ALONG

Block Twelve ^{12 1/2" x 16 1/2"}
Walk in the Park

You can help by donating to St. Jude Children's Research Hospital®: www.FatQuarterShop.com/Snapshots

Snapshots Quilt Along Quilt Kits available.

Cutting:

A	1 - 5 7/8" square		55105-14
B	2 - 4 1/2" squares		
C	2 - 2 1/2" x 6 1/2" rectangles		
D	2 - 2 1/2" squares		
E	2 - 2 1/8" squares		
F	1 - 1 1/2" x 6 1/2" rectangle		
G	2 - 1 1/2" squares		
H	2 - 1 1/2" squares		
I	2 - 1 1/4" x 5 1/2" rectangles		
J	2 - 1" x 6 1/2" rectangles		
K	1 - 1" x 4" rectangle		
L	1 - 1 1/2" x 12" rectangle		 55102-19
M	1 - 5 7/8" square		55104-12
N	2 - 3" x 4" rectangles		
O	1 - 2 1/4" x 10" rectangle		
P	1 - 2 1/4" x 10" rectangle		
Q	2 - 2 1/8" squares		55104-13
R	1 - 2 1/2" x 3" rectangle		55104-17
S	1 - 2" x 2 1/2" rectangle		
T	1 - 1" x 6 1/2" rectangle		
U	1 - 1" x 5" rectangle		
V	1 - 1" x 5" rectangle		
W	1 - 5 1/2" square		55105-17
X	1 - 2" x 5" rectangle		
Y	1 - 2" x 3" rectangle		55108-11
Z	1 - 2" square		

Use 1/4" seams and press as arrows indicate throughout.

Draw a diagonal line on the wrong side of the Fabric A square.

With right sides facing, layer the Fabric A square with the Fabric M square.

Stitch 1/4" from each side of the drawn line.

Cut apart on the marked line.

Partial Handle Unit should measure 5 1/2" x 5 1/2".

Make two.

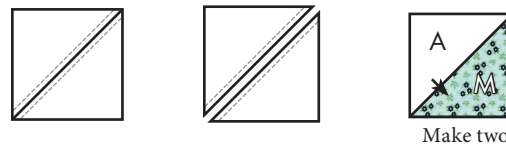

Draw a diagonal line on the wrong side of the Fabric B squares.

With right sides facing, layer a Fabric B square on the bottom right corner of the Partial Handle Unit.

Stitch on the drawn line and trim 1/4" away from the seam.

Handle Unit should measure 5 1/2" x 5 1/2".

Make two.

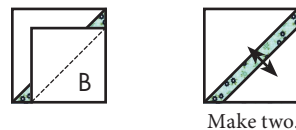

Draw a diagonal line on the wrong side of the Fabric G squares.

With right sides facing, layer a Fabric G square on the top right corner of one Handle Unit.

Pay close attention to unit placement.

Stitch on the drawn line and trim 1/4" away from the seam.

Left Handle Unit should measure 5 1/2" x 5 1/2".

Make one.



1-866-826-2069
www.FatQuarterShop.com
www.YouTube.com/FatQuarterShop

snapshots

QUILT ALONG

Block Twelve 12 1/2" x 16 1/2"
Walk in the Park

You can help by donating to St. Jude Children's Research Hospital®: www.FatQuarterShop.com/Snapshots

With right sides facing, layer a Fabric G square on the top left corner of one Handle Unit.

Pay close attention to unit placement.

Stitch on the drawn line and trim 1/4" away from the seam.

Right Handle Unit should measure 5 1/2" x 5 1/2".

Make one.



Assemble two Fabric I rectangles, the Left Handle Unit and the Right Handle Unit.

Top Basket Unit should measure 5 1/2" x 12".

Make one.

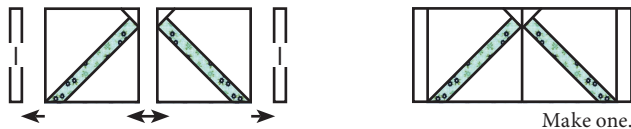

Draw a diagonal line on the wrong side of the Fabric E squares. With right sides facing, layer a Fabric E square with a Fabric Q square.

Stitch 1/4" from each side of the drawn line.

Cut apart on the marked line.

Partial Pinwheel Unit should measure 1 3/4" x 1 3/4".

Make four.



Assemble four Partial Pinwheel Units.

Pinwheel Unit should measure 3" x 3".

Make one.

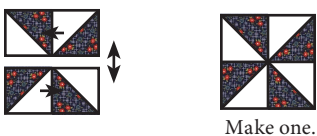

Draw a diagonal line on the wrong side of the Fabric H squares.

With right sides facing, layer a Fabric H square on the bottom left corner of the Fabric O rectangle.

Stitch on the drawn line and trim 1/4" away from the seam.

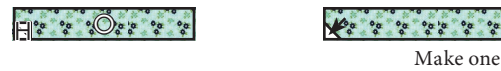

Repeat on the bottom right corner of the Fabric O rectangle.

Bottom Middle Basket Unit should measure 2 1/4" x 10".

Make one.



Assemble the Fabric P rectangle, two Fabric N rectangles, the Pinwheel Unit and the Bottom Middle Basket Unit.

Partial Middle Basket Unit should measure 6 1/2" x 10".

Make one.

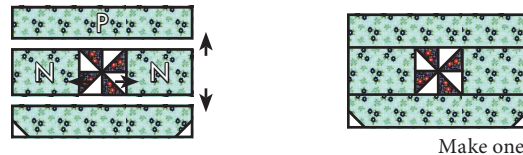

Assemble one Fabric J rectangle and the Partial Middle Basket Unit.

Middle Basket Unit should measure 6 1/2" x 10 1/2".

Make one.

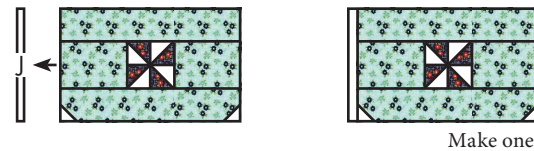

Draw a diagonal line on the wrong side of the Fabric W square.

With right sides facing, layer the Fabric W square on the top left corner of the Middle Basket Unit.

Stitch on the drawn line and trim 1/4" away from the seam.

Partial Bottom Basket Unit should measure 6 1/2" x 10 1/2".

Make one.



You can help by donating to St. Jude Children's Research Hospital®: www.FatQuarterShop.com/Snapshots

Assemble one Fabric J rectangle, the Partial Bottom Basket Unit and the Fabric F rectangle.

Bottom Basket Unit should measure 6 1/2" x 12".

Make one.

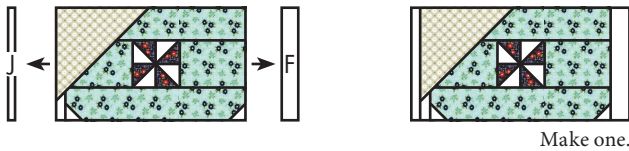

Assemble the Top Basket Unit, the Fabric L rectangle and the Bottom Basket Unit.

Basket Unit should measure 12" x 12 1/2".

Make one.

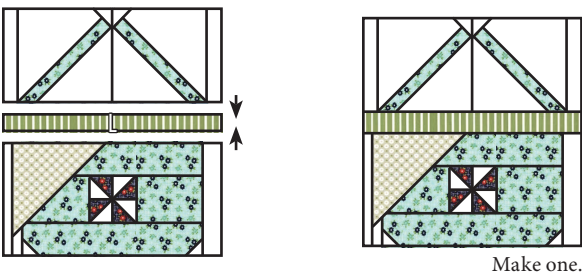

Assemble the Fabric S rectangle, the Fabric Z square, the Fabric K rectangle, the Fabric R rectangle and the Fabric Y rectangle.

Top Wine Glass Unit should measure 4" x 5".

Make one.



Assemble the Fabric X rectangle and the Fabric U rectangle.

Partial Bottom Wine Glass Unit should measure 2 1/2" x 5".

Make one.



Draw a diagonal line on the wrong side of the Fabric D squares.

With right sides facing, layer a Fabric D square on one end of the Partial Bottom Wine Glass Unit.

Stitch on the drawn line and trim 1/4" away from the seam.



Repeat on the opposite end of the Partial Bottom Wine Glass Unit.

Bottom Wine Glass Unit should measure 2 1/2" x 5".

Make one.



Assemble two Fabric C rectangles and the Fabric T rectangle.

Wine Stem Unit should measure 5" x 6 1/2".

Make one.

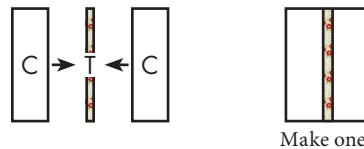

Assemble the Top Wine Glass Unit, the Bottom Wine Glass Unit, the Wine Stem Unit and the Fabric V rectangle.

Wine Glass Unit should measure 5" x 12 1/2".

Make one.

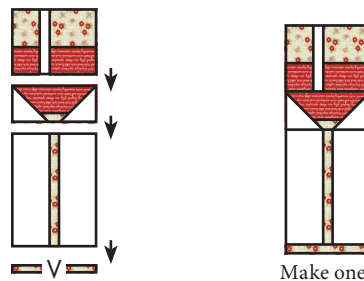

snapshots

QUILT ALONG

Block Twelve ^{12 1/2" x 16 1/2"}
Walk in the Park

You can help by donating to St. Jude Children's Research Hospital®: www.FatQuarterShop.com/Snapshots

Assemble the Walk in the Park Block.

Walk in the Park Block should measure 12 1/2" x 16 1/2".

