

Locket Quilt Pattern

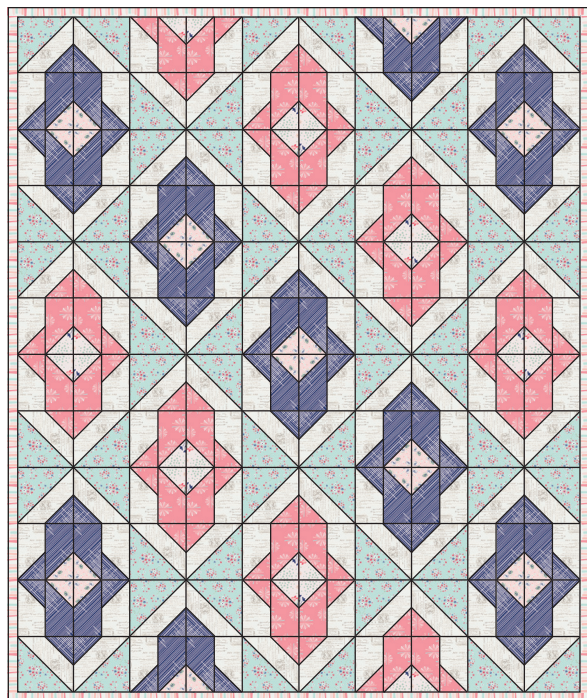

Finished Size: 60 1/2" x 72 1/2"

Cutting:

Cut PPE-347 fabric into:

30 - 6 7/8" squares (Fabric A)

60 - 3 1/2" x 6 1/2" rectangles (Fabric B)



Cut PPE-348 fabric into:

30 - 6 7/8" squares (Fabric C)

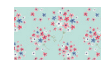

Cut PPE-342 fabric into:

32 - 3 1/2" x 6 1/2" rectangles (Fabric D)

64 - 3 1/2" squares (Fabric E)



Cut PPE-341 fabric into:

32 - 3 1/2" squares (Fabric F)



Cut PPE-345 fabric into:

28 - 3 1/2" x 6 1/2" rectangles (Fabric G)

56 - 3 1/2" squares (Fabric H)



Cut PPE-343 fabric into:

28 - 3 1/2" squares (Fabric I)



Cut PPE-346 fabric into:

8 - 2 1/2" x width of fabric strips (Fabric J)



Fabric Requirements: ★★

2 3/8 yards PPE-347



Fabrics A & B

1 1/3 yards PPE-348



Fabric C

1 1/2 yards PPE-342



Fabrics D & E

1/2 yard PPE-341



Fabric F

1 1/3 yards PPE-345



Fabrics G & H

1/2 yard PPE-343



Fabric I

3/4 yard PPE-346



Fabric J

4 5/8 yards PPE-340
Backing



check out our
YouTube tutorial

The Locket Quilt is made from the Paperie collection by Amy Sinibaldi for Art Gallery Fabrics.

Copyright 2015 Fat Quarter Shop, LLC. All rights reserved. Duplication of any kind is prohibited.

This pattern may be used for personal purposes only and may not be reproduced without the express written permission from the Fat Quarter Shop.

These patterns may not be used for commercial purposes.

1-866-826-2069
www.FatQuarterShop.com
www.YouTube.com/FatQuarterShop



Locket Quilt Pattern



Navy Block: ★★

Use 1/4" seams and press as arrows indicate throughout.

Draw a diagonal line on the wrong side of the Fabric A squares.

With right sides facing, layer a Fabric A square with a Fabric C square.

Stitch 1/4" from each side of the drawn line.

Cut apart on the marked line.

Half Square Triangle Unit should measure 6 1/2" x 6 1/2".

Make sixty.



Make sixty.

Draw a diagonal line on the wrong side of the Fabric E squares.

With right sides facing, layer a Fabric E square on the bottom right corner of a Half Square Triangle Unit.

Stitch on the drawn line and trim 1/4" away from the seam.

Navy Square Unit should measure 6 1/2" x 6 1/2".

Make thirty-two.



Make thirty-two.

Assemble two Navy Square Units.

Top Navy Unit should measure 6 1/2" x 12 1/2".

Make sixteen.

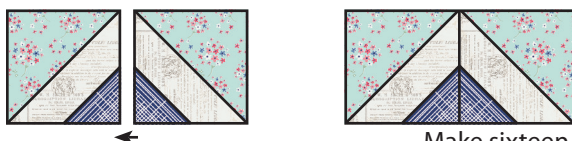

Make sixteen.

With right sides facing, layer a Fabric E square on the bottom end of a Fabric B rectangle.

Stitch on the drawn line and trim 1/4" away from the seam.

Left Navy Rectangle Unit should measure 3 1/2" x 6 1/2".

Make sixteen.



Make sixteen.

With right sides facing, layer a Fabric E square on the bottom end of a Fabric B rectangle.

Stitch on the drawn line and trim 1/4" away from the seam.

Right Navy Rectangle Unit should measure 3 1/2" x 6 1/2".

Make sixteen.



Make sixteen.

Draw a diagonal line on the wrong side of the Fabric F squares.

With right sides facing, layer a Fabric F square on the bottom end of a Fabric D rectangle.

Stitch on the drawn line and trim 1/4" away from the seam.

Inner Left Navy Rectangle Unit should measure 3 1/2" x 6 1/2".

Make sixteen.

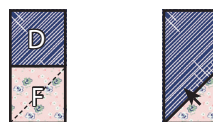

Make sixteen.



Locket Quilt Pattern



With right sides facing, layer a Fabric F square on the bottom end of a Fabric D rectangle.

Stitch on the drawn line and trim $\frac{1}{4}$ " away from the seam.

Inner Right Navy Rectangle Unit should measure $3\frac{1}{2}$ " x $6\frac{1}{2}$ ".

Make sixteen.

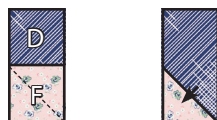

Make sixteen.

Assemble the Left Navy Rectangle Unit, the Inner Left Navy Rectangle Unit, the Inner Right Navy Rectangle Unit and the Right Navy Rectangle Unit.

Bottom Navy Unit should measure $6\frac{1}{2}$ " x $12\frac{1}{2}$ ".

Make sixteen.

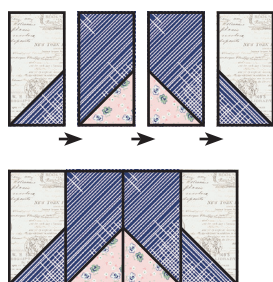

Make sixteen.

Assemble the Navy Block

Navy Block should measure $12\frac{1}{2}$ " x $12\frac{1}{2}$ ".

Make sixteen.

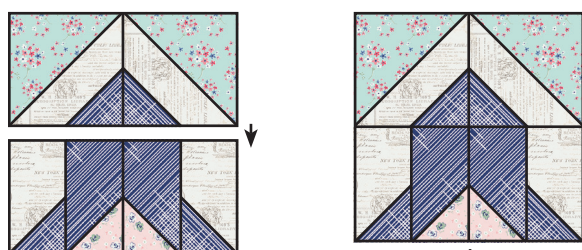

Make sixteen.

Pink Block: ★★

Draw a diagonal line on the wrong side of the Fabric H squares.

With right sides facing, layer a Fabric H square on the top right corner of a Half Square Triangle Unit.

Stitch on the drawn line and trim $\frac{1}{4}$ " away from the seam.

Pink Square Unit should measure $6\frac{1}{2}$ " x $6\frac{1}{2}$ ".

Make twenty-eight.



Make twenty-eight.

Assemble two Pink Square Units.

Bottom Pink Unit should measure $6\frac{1}{2}$ " x $12\frac{1}{2}$ ".

Make fourteen.

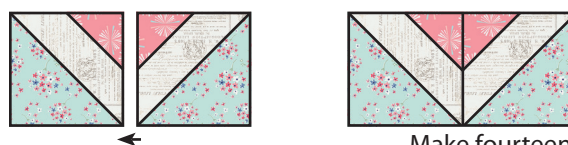

Make fourteen.

With right sides facing, layer a Fabric H square on the top end of a Fabric B rectangle.

Stitch on the drawn line and trim $\frac{1}{4}$ " away from the seam.

Left Pink Rectangle Unit should measure $3\frac{1}{2}$ " x $6\frac{1}{2}$ ".

Make fourteen.



Make fourteen.



Locket Quilt Pattern



With right sides facing, layer a Fabric H square on the top end of a Fabric B rectangle.

Stitch on the drawn line and trim $\frac{1}{4}$ " away from the seam.

Right Pink Rectangle Unit should measure $3\frac{1}{2}$ " x $6\frac{1}{2}$ ".

Make fourteen.



Make fourteen.

Draw a diagonal line on the wrong side of the Fabric I squares.

With right sides facing, layer a Fabric I square on the top end of a Fabric G rectangle.

Stitch on the drawn line and trim $\frac{1}{4}$ " away from the seam.

Inner Left Pink Rectangle Unit should measure $3\frac{1}{2}$ " x $6\frac{1}{2}$ ".

Make fourteen.



Make fourteen.

With right sides facing, layer a Fabric I square on the top end of a Fabric G rectangle.

Stitch on the drawn line and trim $\frac{1}{4}$ " away from the seam.

Inner Right Pink Rectangle Unit should measure $3\frac{1}{2}$ " x $6\frac{1}{2}$ ".

Make fourteen.



Make fourteen.

Assemble the Left Pink Rectangle Unit, the Inner Left Pink Rectangle Unit, the Inner Right Pink Rectangle Unit and the Right Pink Rectangle Unit.

Top Pink Unit should measure $6\frac{1}{2}$ " x $12\frac{1}{2}$ ".

Make fourteen.

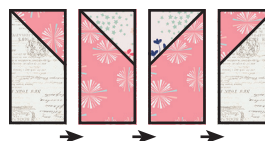

Make fourteen.

Assemble the Pink Block.

Pink Block should measure $12\frac{1}{2}$ " x $12\frac{1}{2}$ ".

Make fourteen.

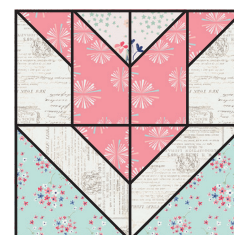
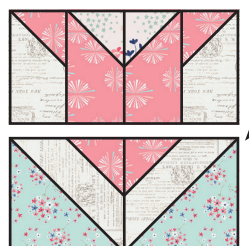

Make fourteen.



Locket Quilt Pattern



Quilt Center: ★★

Assemble the Quilt Center.

Pay close attention to unit placement.

Press rows in alternating directions.

Quilt Center should measure 60 1/2" x 72 1/2".

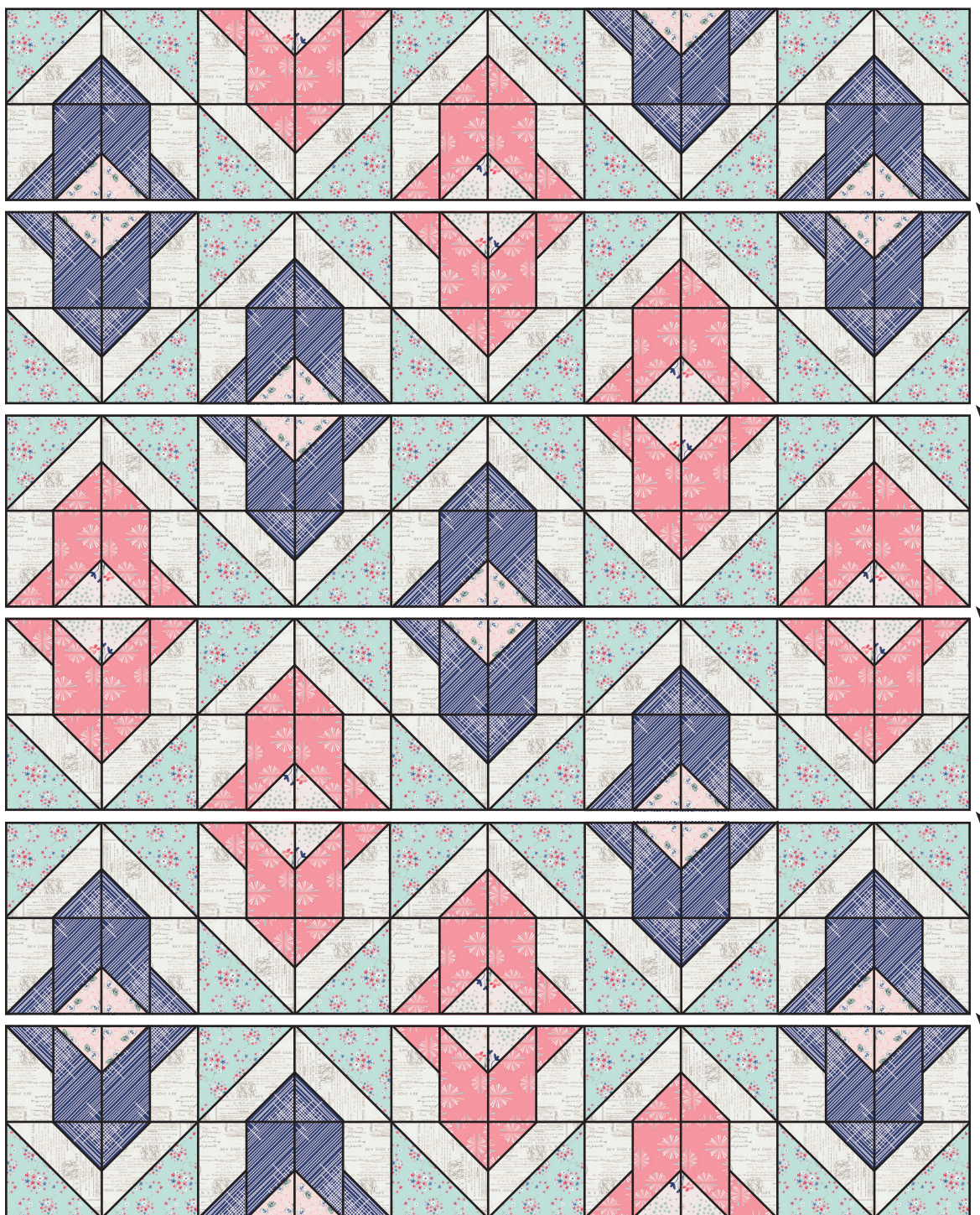

Locket Quilt Pattern



Finishing: ★★

Piece the Fabric J strips end to end for binding.

Quilt and bind as desired.

