

Two by Two Receiving Blanket

www.FatQuarterShop.com



Finished size: 26" x 26"

The Two by Two Receiving Blanket features the Little Ark collection by Carina Gardner for Riley Blake Designs.



Free quilt pattern by Sarah Price

Copyright 2014 Fat Quarter Shop, LLC. All rights reserved. Duplication of any kind is prohibited.

This pattern may be used for personal purposes only and may not be reproduced without the express written permission from the Fat Quarter Shop. These patterns may not be used for commercial purposes.

Two by Two Receiving Blanket

Fabric Image	SKU	Yardage	Description	Quantity & Size		
	C3833-AQUA	1/4 yard	Quilt Center	A	4	7" squares
	C3834-AQUA	1/4 yard	Quilt Center	B	4	7" squares
	C3831-AQUA	1/4 yard	Quilt Center	C	4	7" squares
	C3830-AQUA	1/4 yard	Quilt Center	D	4	7" squares
	C3834-GRAY	7/8 yard	Backing	E	1	28" square

Use 1/4" seams and press as arrows indicate throughout.

Quilt Center:

Assemble one Fabric A square, one Fabric B square, one Fabric C square and one Fabric D square as shown.

First Row should measure 7" x 26 1/2".

Make one.

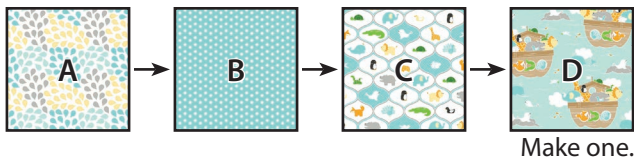

Assemble one Fabric D square, one Fabric A square, one Fabric B square and one Fabric C square as shown.

Second Row should measure 7" x 26 1/2".

Make one.

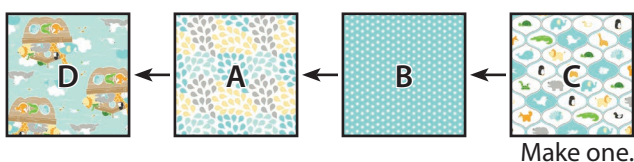

Assemble one Fabric C square, one Fabric D square, one Fabric A square and one Fabric B square as shown.

Third Row should measure 7" x 26 1/2".

Make one.

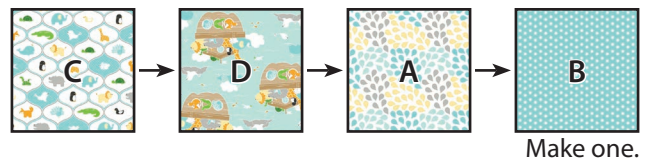

Assemble one Fabric B square, one Fabric C square, one Fabric D square and one Fabric A square as shown.

Fourth Row should measure 7" x 26 1/2".

Make one.

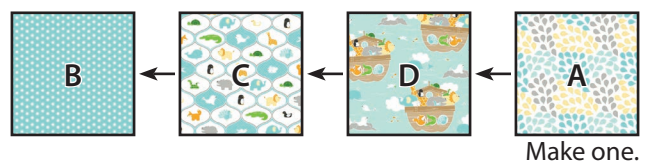

Two by Two Receiving Blanket

Assemble the First Row, the Second Row, the Third Row and the Fourth Row as shown.

Quilt Top should measure 26 1/2" x 26 1/2".

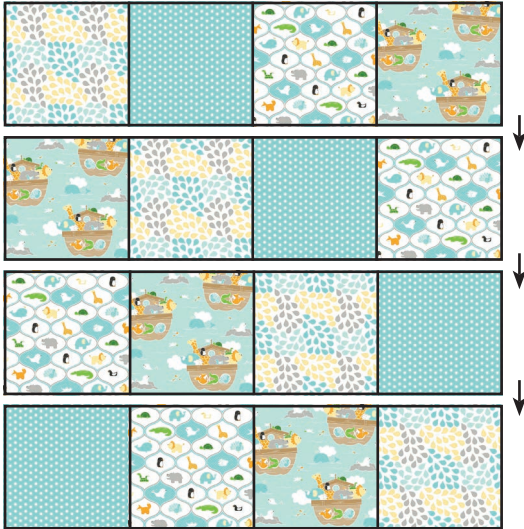

To add curved edges use the 3" section of the Creative Grids Non-Slip Multi-Size Curved Corner Cutter Ruler or the template provided on page 4.

Cut each corner using a rotary cutter.

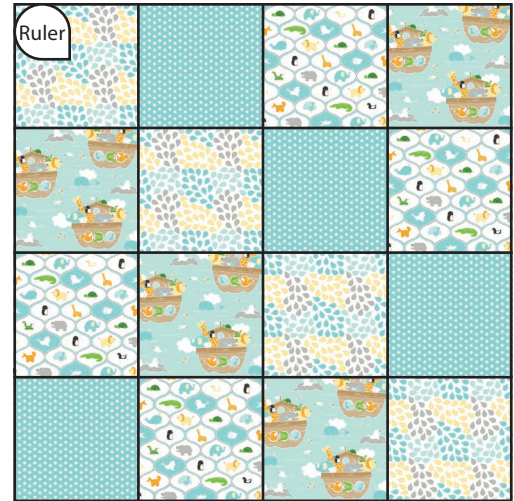

Finishing:

With right sides facing, layer the Quilt Top with the Fabric E Square. Square up the Fabric E Square using the Quilt Top as a guide.

Pin in place as you are trimming the Fabric E Square to the same size as the Quilt Top.

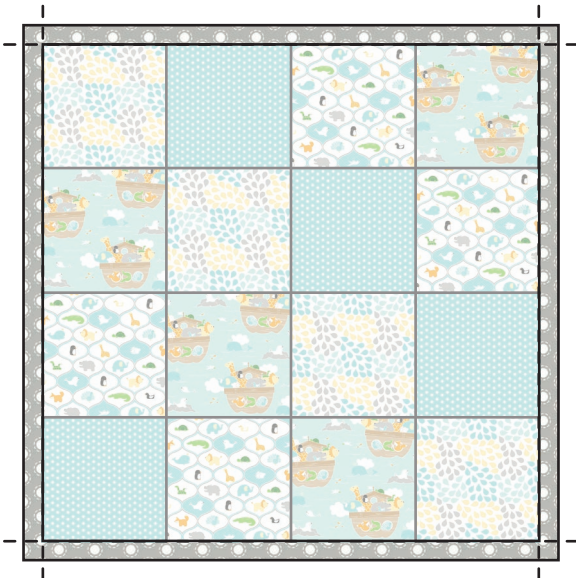

Stitch around the Receiving Blanket using a 1/4" seam. Leave an 8" opening at the bottom. Backstitch at the beginning and end.

Turn the Receiving Blanket right side out.

Press the opening edges under 1/4" and press closed.

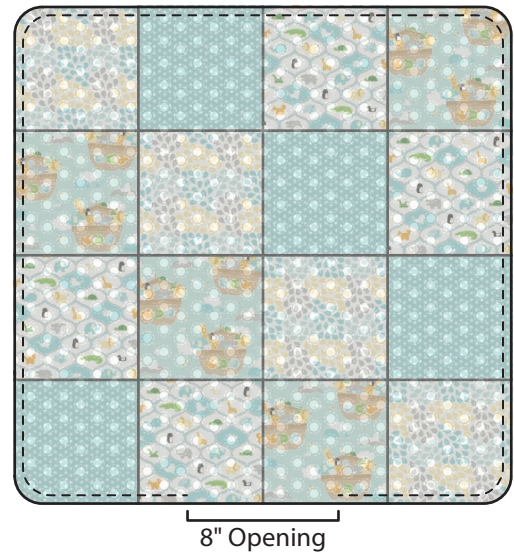

Two by Two Receiving Blanket

Stitch around the Receiving Blanket $\frac{1}{8}$ " from the edge. Use matching thread. Backstitch at the beginning and end.

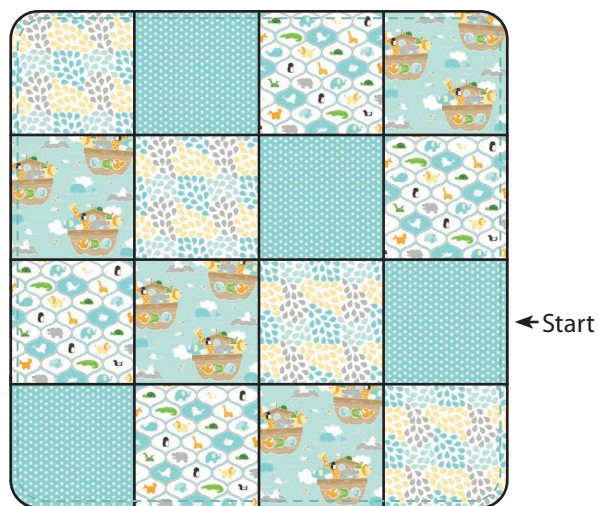

Secure the quilt top and backing together by stitching in the center seams of the quilt. Use matching thread. Backstitch at the beginning and end.

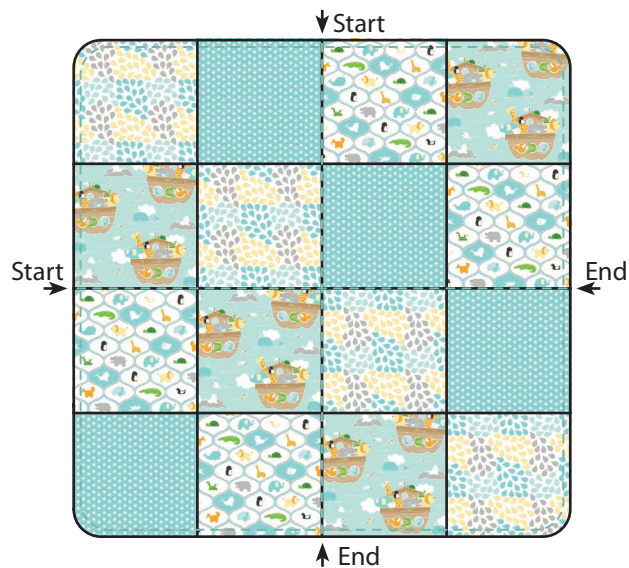

If you do not have the Creative Grids Non-Slip Multi-Size Curved Corner Cutter Ruler use the template provided below or any kitchen bowl for your desired curve shape.

3" Curved Shape Template